



USE ITEM 8, QUICK SPLICE, TO CONNECT TO HYDRAULIC PUMP POWER WIRE ON A HYDRA BED SYSTEM.

CONNECT TO SWITCHED AND FUSED POWER LEAD FOR OTHER APPLICATIONS.



STRIP JACKET FROM WIRES AND MAKE CONNECTIONS AS SHOWN.

3. PROVIDED WIRES MAY BE CUT TO LENGTH TO MAKE CONNECTIONS.

MAKE CONNECTIONS AND
MOUNT DISPLAY IN DESIRED LOCATION

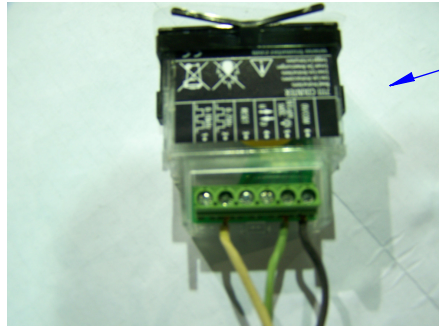

ROUTE ITEM 4, WIRE, TO DESIRED
DISPLAY LOCATION AND MAKE
CONNECTIONS.

1	High Speed Count Input
2	Low Speed Count Input
3	External Reset Input
4	Direction Input
5	External power of backlight
6	OV, Common

ITEM	PART NUMBER	DESCRIPTION	QTY
1	N121.01A	DIGITAL DISPLAY	1
2	VELCRO	VELCRO FASTENER	1-1/2 IN
3	W62185	18/2 JACKETED WIRE	17 FT
4	W18/3 SVO	18/3 JACKETED WIRE	3 FT
5	BC422005	BLUE BUTT CONNECTOR	3
6	RT152565	RING TERMINAL, 5/16	1
7	W37140	14 GA WIRE, BLACK	2 FT
8	QS905595	QUICK SPLICE, BLUE	1
9	HF12-64	BRACKET, DISPLAY	1
10	PF690005	RED PUSH ON FEMALE	2
11	PM630005	RED PUSH ON MALE	2
12	8-32x1 MS SS	MACHINE SCREW	1
13	8-32 HNN SS	NYLOCK NUT	1
14	10316	SENSOR	1
15	MAG .75 HIENERG	MAGNET	1

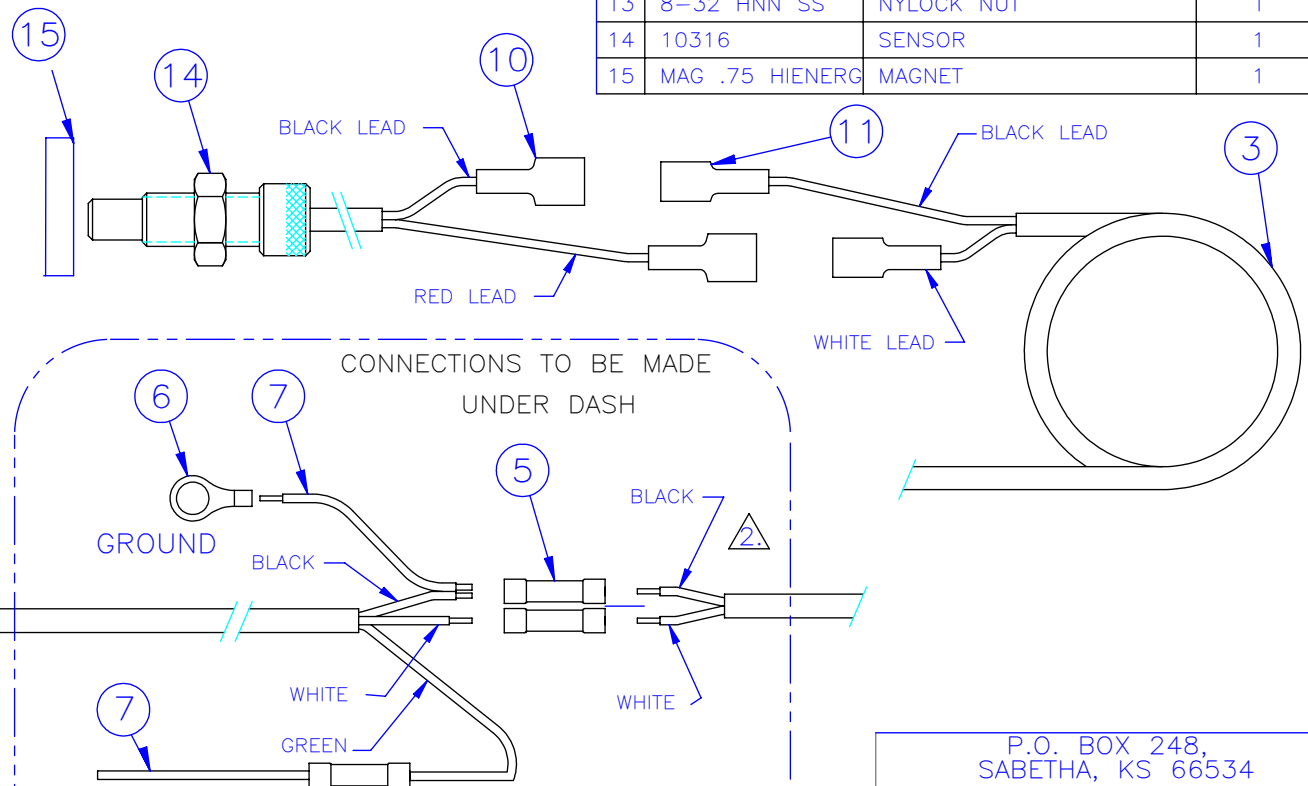

TO POWER

PROPRIETARY AND CONFIDENTIAL
THE INFORMATION CONTAINED IN THIS
DRAWING IS THE SOLE PROPERTY OF TRIPLE
C INC. ANY REPRODUCTION IN PART OR
AS A WHOLE WITHOUT THE WRITTEN
PERMISSION OF TRIPLE C INC. IS PROHIBITED

DIMENSIONS ARE IN INCHES
TOLERANCES:
FRACTIONAL $\pm 1/16$
ANGULAR: MACH ± 1 BEND \pm
TWO PLACE DECIMAL ± 010
THREE PLACE DECIMAL ± 005

MATERIAL --

DO NOT SCALE DRAWING

	NAME	DATE
DRAWN	HEATH	12/26/2012
PART #	EF-CKE	
ASM #		
COMMENTS:		
SENSOR KIT ECONOMY COUNTER ELECTRIC FEEDER		

P.O. BOX 248,
SABETHA, KS 66534

TRIPLE C
INC.

SIZE A	DWG. NO. 30-1806	REV. A
SCALE: 1:1	WEIGHT: --	SHEET 1 OF 1